

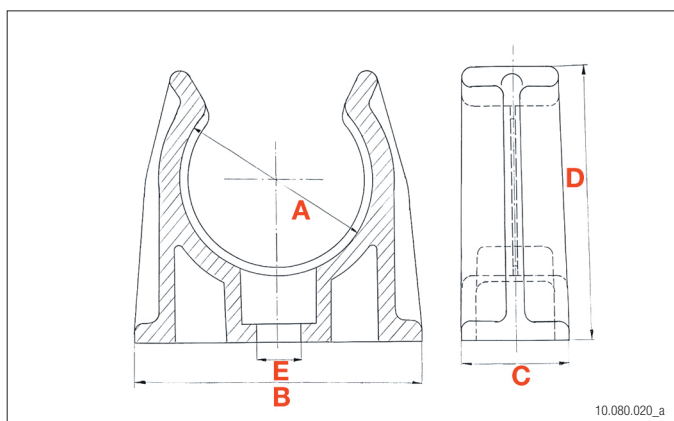

UH



MAT Polypropylen
Polypropylène
Polypropylene

TEMP -20°C bis +190°C
-20°C à +190°C
-20°C to +190°C

HALO halogenfrei
sans halogène
halogen free

 flammhemmend
combust. retardée
flame resistant

UV schwarz: UV-beständig
noir: UV-résistant
black: UV-resistant

RoHS

Schlauchhalter UH







Wird als Stützpunkthalter an Maschinen für die Befestigung von Wellschläuchen eingesetzt. Schnelle Montage durch Einlochbefestigung, Schläuche nur einschnappen. Durch die Doppelrippe des Halters optimale Zugentlastung. Fixierung in Längsrichtung, um die eigene Achse drehbar.

Support de gaine UH

Pour le montage de gaine sur machine, le support remplit les deux fonctions, soit support et arrêt de gaine, les trous de fixations sont normalisées, mise en place rapide et fonctionnelle d'une gaine, en installation fixe ou tournante. Ancrage de la gaine par les ergots intégrés dans le support.

Conduit holder UH

Used as intermediate support point for corrugated conduits, single hole allows quick installation. The hose is simply snapped into the conduit holder. Excellent strain relief. Conduit may rotate freely.

NORM NW/DN	A mm	B mm	C mm	D mm	E mm			Plica-Nr.	E-Nr.	VE
10	13.0	30.0	12.5	23.5	4.5			80.8202.090	126 140 111	100
8.5/10	13.0	30.0	12.5	23.5	4.5			80.8201.709	126 140 101	100
12/13	16.0	30.0	12.5	23.5	4.5			80.8202.111	126 140 211	100
								80.8201.711	126 140 201	100
14	17.8	24.0	20.0	26.1	5.5			80.8202.143	126 140 311	100
17	20.5	35.0	15.5	30.5	5.5			80.8202.162	126 140 411	100
								80.8201.716	126 140 401	100
20	26.0	35.0	20.0	39.6	7.1			80.8202.203	126 140 911	50
23	28.5	42.5	16.5	38.0	6.5			80.8202.219	126 140 511	100
22-26	28.5	42.5	16.5	38.0	6.5			80.8201.721	126 140 501	100
29	34.5	51.5	17.5	43.5	6.5			80.8202.294	126 140 611	50
								80.8201.729	126 140 601	50
37	40.5	61.0	19.0	51.0	6.5			80.8202.367	126 140 711	50
36	40.5	61.0	19.0	51.0	6.5			80.8201.736	126 140 701	50
48	52.0	73.5	19.5	63.5	6.5			80.8202.480	126 140 811	50
	53.5	73.5	19.5	63.5	6.5			80.8201.748	126 140 801	50